



BARCODE HANDY SCANNER

AIDA 9560



Barcode model



The CCD scanner allows a wide reading range from close-up to distant

Light and compact body with cross-top lever relieves the burden of long-time operation

Durable cross-top lever gives you peace of mind even in emergency



This barcode scanner aims to provide comfort for long-time use. Maneuverability and durability are realized with the cross-top lever design.

Reading performance

Operation efficiency up! High-speed reading

With the built-in high-end "Advanced Scan Plus" technology, the scanner reads two times as faster than all the previous devices, reading barcodes in continuous inspections and thus contributing to the improvement of operation efficiency.



Wide range reading

Both close-up and long-distance readings are possible. The scanner zooms in on the object for reading with no need to sense its position.

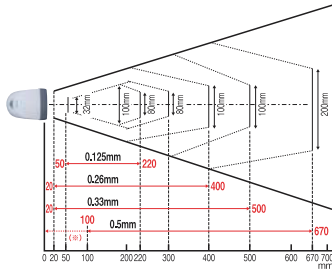

* The broken lines (---) indicate the barcode widths beyond the possible reading widths of 9560.

Even the wide barcode is read smoothly

Can be used for wide bar codes such as logistic ITF, utility bills, medical supplies GS1-128 (EAN 128), CODE 39 of EIA labels.



Design

Light weight and compact body, the ultimate pursuit of "easiness of use"

- Operator's "easiness of use" is totally realized through the light weight and compact body. The burden of long-time operation is relieved.
- Easy-to-grip swelling shape is the perfect fit with the palm.



Durability

Impact resistant cross-top lever gives you peace of mind even in emergency.

The outstanding durability is well proven through repeated drop test from the height of approximately 1.8m. You can use with peace of mind even in emergency.



Anti-bacteria and weather durable design allows long-time use in a clean condition

The body is made of anti-bacteria and weather durable materials* which inhibit bacteria growth and prevent color changes caused by sunlight, you can use it for a long time with peace of mind.



* Source: conformity with the JIS Z 2081.

Specification

		AIDA 9560
Scanner part	Type	Advanced scanner plus
	Scan Rate	Dynamic scanning rate up to 500 scans per second
	Applicable Code	EAN-13/8(JAN-13/8) · UPC-A/E · UPC/EAN(with add-on) · Interleaved 2of5(ITF) · CODABAR(NW-7) · CODE39 · CODE93 · CODE128 · GS1-128(EAN-128) · RSS(GS1 DataBar) · RSS(GS1 DataBar)
	Minimum resolution	0.1 mm
	Marker	LED marker
	P.C.S value	Over0.3
	Inclination and elevation angles	±50°
Communication Interface	Type	RS-232C · USB(COM) · HID *1
	Connector	Dsub-9S · USB connector (A type)
Power	Cable	3m straight cable · 2m straight
	Power supply	Exclusive AC adapter · Supplied from connecting point
Environment conditions	Protection level	IP42
	Drop durability *2	1.8m
	Operation temp. range	-5~50°C
	Operation humidity range	10~90%RH (No frosting and freezing)
	Operation ambient illumination	20~10,000 lux (white fluorescent light)
Mass (excluding cable)	Approximately 105g	

*1: USB keyboard interface and USB-COM interface are supported. *2: Test value, not guarantee value.

Dimension drawing

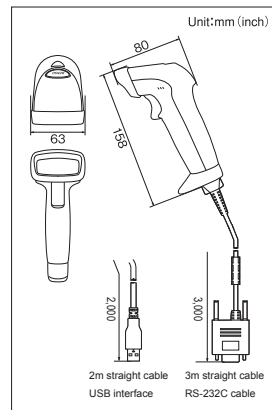

Contact Us: If you have further enquiries, please contact us for more information & discussion.

Million Tech Development Limited

Address: Unit 509, 5/F, Tower II, Cheung Sha Wan Plaza, 833 Cheung Sha Wan Road, Kowloon, Hong Kong

General Line: (852) 2788 3306
 Sales Enquiry: (852) 2784 2868
 Service Hotline: (852) 2784 2888

F a x : (852) 2319 2967
 Email: sales@milliontech.com
 Email: helpdesk@milliontech.com

Website: <https://milliontech.com>