

DENSO

WIRELESS SCANNER

NEW SE1 SERIES



2D code model
SE1-QB



Barcode model
SE1-BB



Data entry to smart devices is now easier, quicker and more accurate!



iOS Android Windows® supported!

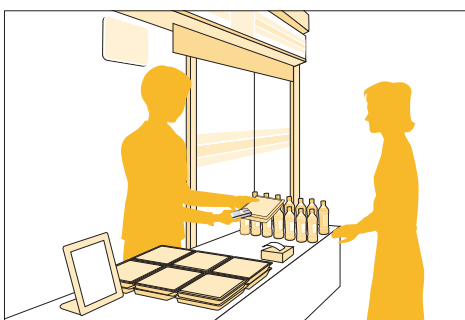

Simplifies POS use at stores

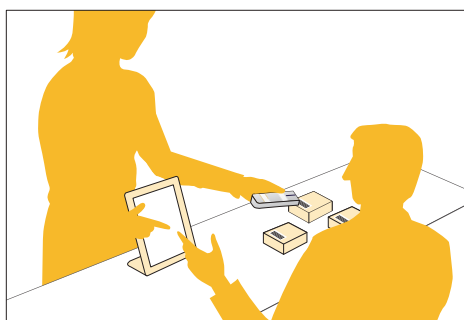

For route salespersons



Helps prevent medical errors in hospitals

Feature 1

Long operation

This scanner can be operated for a long time, reducing operating costs. Even if suddenly out of battery power, there's no need to worry; this scanner is battery-powered.



Feature 2

Supports LCD scanning

Scanning codes displayed on a smartphone or other device is also supported.



Feature 3

Connects to all detected Bluetooth® devices

No complicated settings required. Do settings by just scanning the connection code.

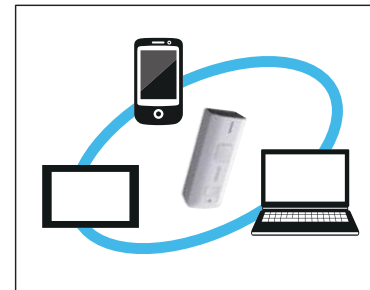

SE1 series specifications

		2D code model		Barcode model	
Type		SE1-QB		SE1-BB	
Scanner		Area sensor		Advanced scan plus (CCD)	
Mode	Readable codes	2D code	QR code, micro QR code, iQR, SQRC, PDF417, DataMatrix (ECC200), Aztec, GS1 Composite (EAN.UCC Composite), Maxi Code	-	
		Barcode	EAN-13/8 (JAN-13/8), UPC-A/E, UPC/EAN (with add-on), Interleaved 2 of 5 (ITF), CODABAR (NW-7), Standard 2 of 5 (STF), CODE39, CODE93, CODE128, GS1-128 (EAN-128), GS1 DataBar (RSS)	EAN-13/8 (JAN-13/8), UPC-A/E, UPC/EAN (with add-on), Interleaved 2 of 5 (ITF), CODABAR (NW-7), CODE32, CODE39, CODE93, CODE128, GS1-128 (EAN-128), GS1 DataBar (RSS), Standard 2 of 5 (STF), MSI, Plessey	
Minimum resolution	2D code	0.167 mm		-	
	Barcode	0.125 mm		-	
PCS value		0.3 min.		-	
Angle		±50°		-	
Scanning confirmation		Confirmation LED (blue, red), Buzzer		-	
Communication interface	Method	Bluetooth ver. 2.1 + EDR-based class 2		-	
	Profile	SPP, HID		-	
Power	Power	Alkaline AA battery x 2 or AA Eneloop® battery x 2		-	
	Operating time*1	50 hours		100 hours	
Environment requirements	Security level	IPX2		-	
	Drop impact resistance*2	1.2 m high over a concrete floor with 6 times		-	
	Operating temperature	-5~50°C		-	
Weight		Approx. 60 g (not including batteries)			

*1: With one reading pass over a 5 s period.

*2: These are test values, but not guaranteed values.

Product configuration

Accessories

- Scanner
- Operation Guide (with code menu for settings)
- * Batteries are not included.

Software

- Setting software (Scan Tune App)
- Software application to prepare parameter setting codes for SE1 series on PC.
- * Downloadable via QBdirect.

Option (sold separately)

- Neck strap (NSBHT-500)
- Hand strap (HSSE1)

Silicone cover

- Silicone cover common to SE1-BB and -QB (Clear)
- Silicone cover common to SE1-BB and -QB (Black)

Dimensions

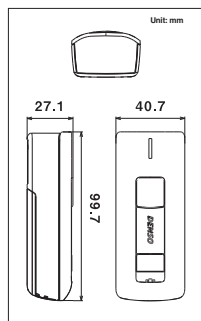

Scanning performance

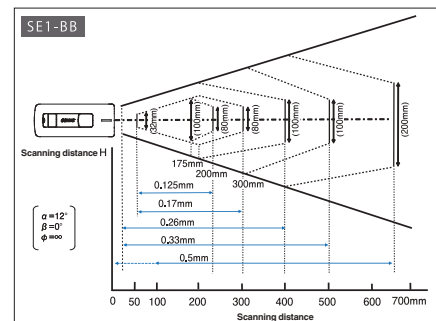
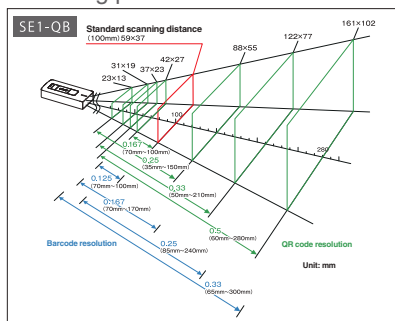

To use this product safely

- Before using this product, please read its User's Manual thoroughly for correct use.

